

# Plat of Survey

of

## Lots 1 & 2 in Block 8 of Genevista,

a subdivision located in the Southwest 1/4 of the Southwest 1/4 of Section 10,  
Town 1 North, Range 17 East, Town of Linn, Walworth County, Wisconsin.

ALSO, A parcel of land described in an Abridgment of Judgment recorded in Vol. 593  
on Page 271 as Document No. 243647, as shown below:

Beginning at the Northwest corner of Lot 1, Block 8, Genevista Subdivision; thence East  
25 feet to the centerline of the vacated roadway; thence South 158 feet along the center-  
line of said roadway; thence East 25 feet; thence North 158 feet along the West line of  
said lot to the point of beginning.

Surveyed for: **Jean M. Barry Trust**  
2729 North Dayton Street  
Chicago, Illinois. 60614

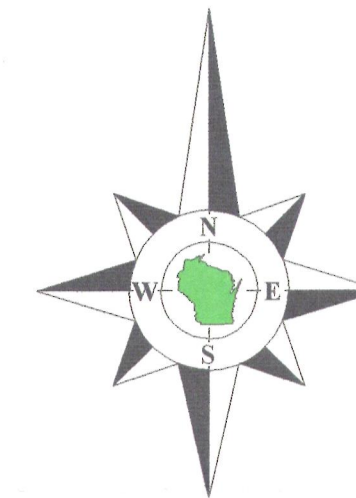

Bearings reference to previous  
surveys of record.

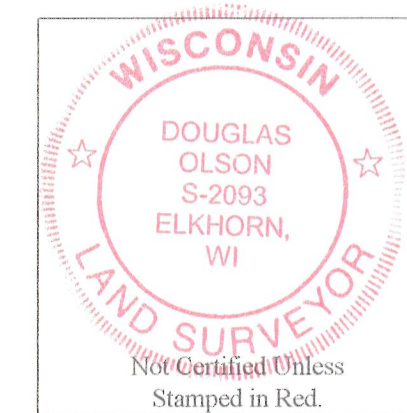

### Notes:

- 1) This survey plat is not certified unless signed and sealed in red ink.
- 2) This survey is subject to Wisconsin lien laws. This Plat of Survey is the notice of intent to file lien. Lien waiver required.

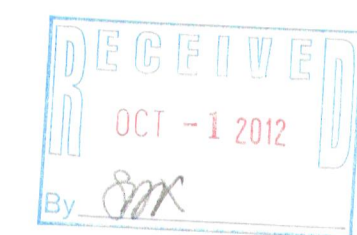

Copyright 2012 by Jensen & Olson Land Surveying, LLC.

All rights reserved. No part of this survey plat may be reproduced or transmitted in any form by any means - graphic, electronic, or mechanical, including photocopying, tracing, or information storage and retrieval systems - without permission in writing from Douglas G. Olson, Jensen & Olson Land Surveying, LLC.

I, Douglas G. Olson, Wisconsin Registered Land Surveyor, do hereby certify that this survey was performed by me, or under my direction in full compliance with the owner's/agent's instructions and Chapter A-E 7 of the Wisconsin Administrative Code "Minimum Standards for Property Surveys"; and that this map is an accurate representation thereof to the best of my knowledge and belief.

Douglas G. Olson  
Wisconsin Registered Land Surveyor - 2093

Survey Date: July 27, 2012.  
Revisions: No. 1 - Set Lath Proposed House  
No. 2 - Deck & Garage

Scale in Feet  
1" = 20'  
0 10' 20' 40'

**Jensen & Olson Land Surveying, LLC**  
45 South Wisconsin Street \* P.O. Box 322 \* Elkhorn, Wisconsin. 53121  
Telephone: (262) 723-3434 \* Facsimile: (262) 723-8044  
Email: jensen.olson@elknet.net

**Legend**  
Location of buried gas line as flagged by 1" dia. Diggers Hotline  
Found Iron Pipe  
Set Iron Pipe  
Set Wood Lath  
Recorded Information  
Utility Pole  
Septic Vent  
Concrete Cover  
Concrete Surface  
Gravel Surface

Sheet 1 of 1 Sheets  
Drawing Name: Unit 1-201208-20120801.dwg  
Job Reference Number  
**2012.058**

**2012.058**

IGN-40A

117-3452